

# LMBZ and LMBX Carriage Blocks

Sliders series LMBZ26-3, LMBX26-3 with 3 rollers

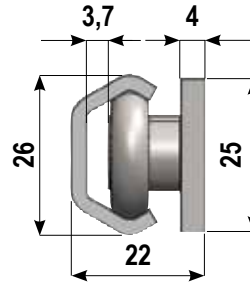

Slider	Co rad (N)	Co ax (N)	Mx (Nm)	My (Nm)	Mz (Nm)	Weight (gr)
LMBZ 26-3 LMBX 26-3	800	400	3	9	12	100

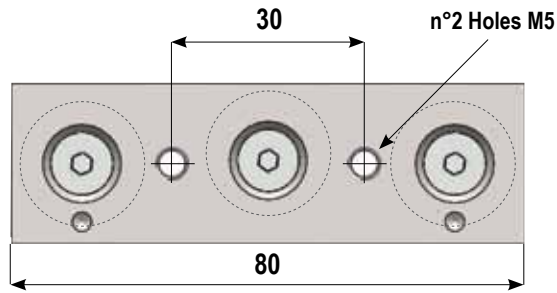

Sliders series LMBZ2-3, LMBX2-3 with 3 rollers

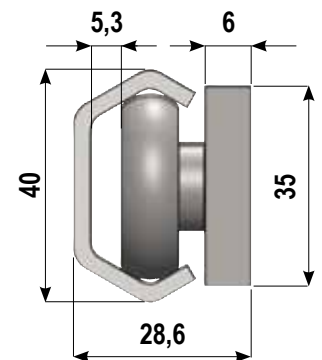
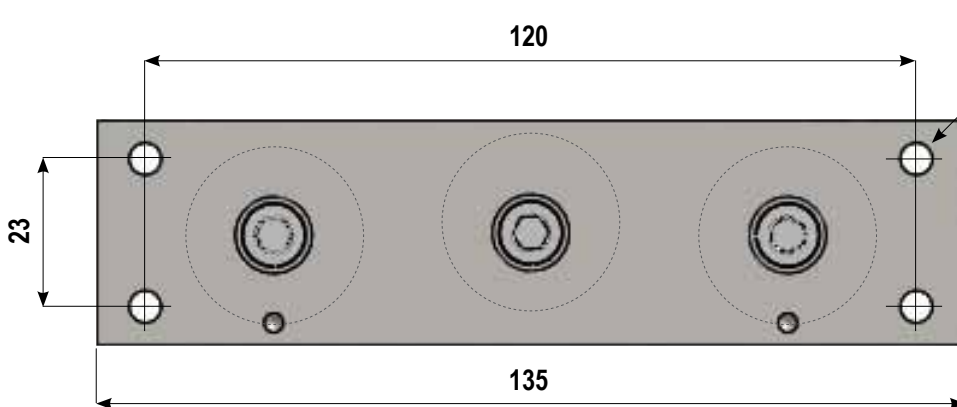

Sliders	Co rad (N)	Co ax (N)	Mx (Nm)	My (Nm)	Mz (Nm)	Weight (gr)
LMBZ2-3 LMBX2-3	1600	800	9	23	32	430

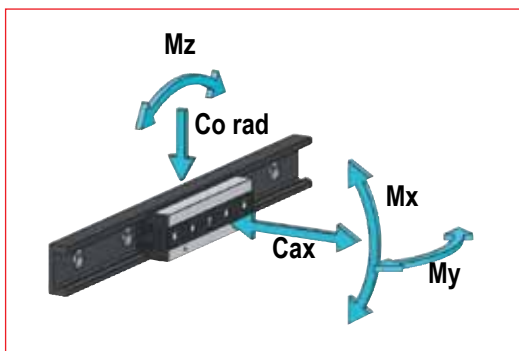

LM76 Linear Motion Bearings  
 140 Industrial Drive  
 East Longmeadow 01028  
 1-800-513-3163  
 Fax: 413-525-3735  
 www.LM76.com

# New from **LM76** Defender 2 Rail and Roller Block System



## LMX 2 series rails

LMRX2 series rail & LMBX series sliders are constructed entirely of stainless steel and are a simple and functional solution for applications that require high corrosion resistance.

The rails and sliders bodies are made from 300 Series stainless with rollers made from 440C.

These are particularly suitable for food processing, pharmaceutical, and medical applications or in difficult environments such as marine environments where there is exposure to highly corrosive agents.

The slider is equipped with 3 rollers. The middle roller is eccentric and is used to adjust the slider preload.

## LMZ 2 series rails

LMZ sliders are dimensionally identical to the LAX and PAX - Series but are much lower in cost because they are made of Zinc plated steel.

The minimum space requirements, internal protected raceways, amazing ease of assembly, and good load capacity makes this linear bearing system an excellent choice compared to other solutions available on the market

## LMRZ2 and LMRX2 rails

We cut rails to size. Send us a print for quotation

Linear rail dimensions

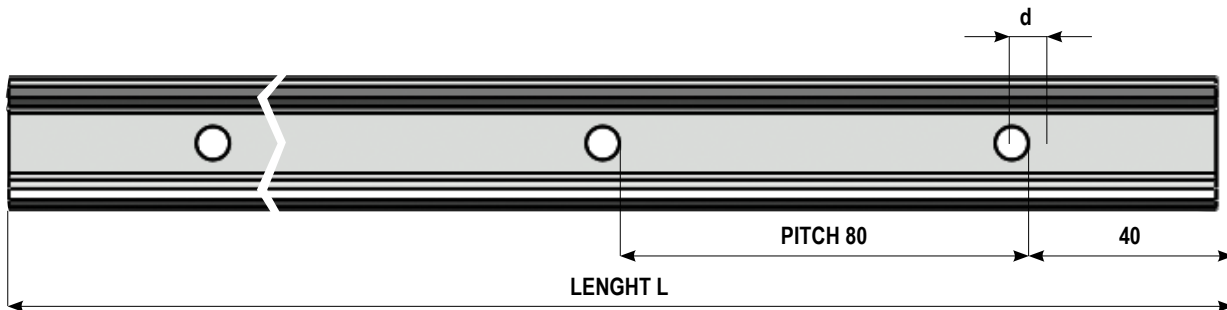

Rail code	A (mm)	B (mm)	C (mm)	d (mm)	E (mm)	Fixing screws	Weight (kg)
LMRZ 26	26	14	9,5	6,5	2,5	M5 - ISO 7380	0,67
LMRX 26							
LMZR 2	40	21,3	13,3	9	3	M8 - ISO 7380	1,55
LMXR 2							

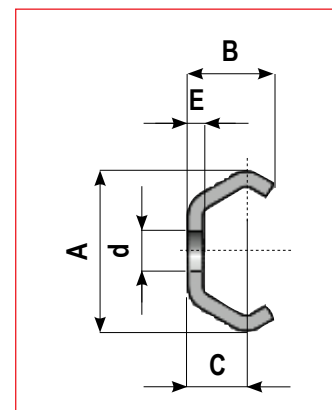

Suitable fixing screws of type ISO 7380

